

Check Development Length of Bars

SDC	F
Ψ_t	1.00
Ψ_e	1.00
λ	1.00
l_d [in]	24.00
l'_d [in]	9.00
l_d [in]	24.00
min. clear spacing [in]	1.00
min. clear cover [in]	0.50

seismic design category (A,B,C,D,E, or F)

(ACI 318-08, 12.2.4(a))

(ACI 318-08, 12.2.4(b))

(ACI 318-08, 12.2.4(d))

development length to yield (ACI 318-08, 12.2.2, no stirrups or ties)

development length when yielding not req'd (ACI 318-08, 12.2.5)

minimum req'd development length of deformed bars

(ACI 318-08, 12.2.2)

(ACI 318-08, 12.2.2)

Results:

Steel Base Plate:

f_y	50 ksi
t	0.750 in
b	5 in
L	10 in

Deformed Bars:

f_y	70.0 ksi
d_b	0.5 in
n	2.0 bars
s	6.0 in
l_d	24.0 in
min. clear spacing	1.0 in
min. clear cover	0.5 in

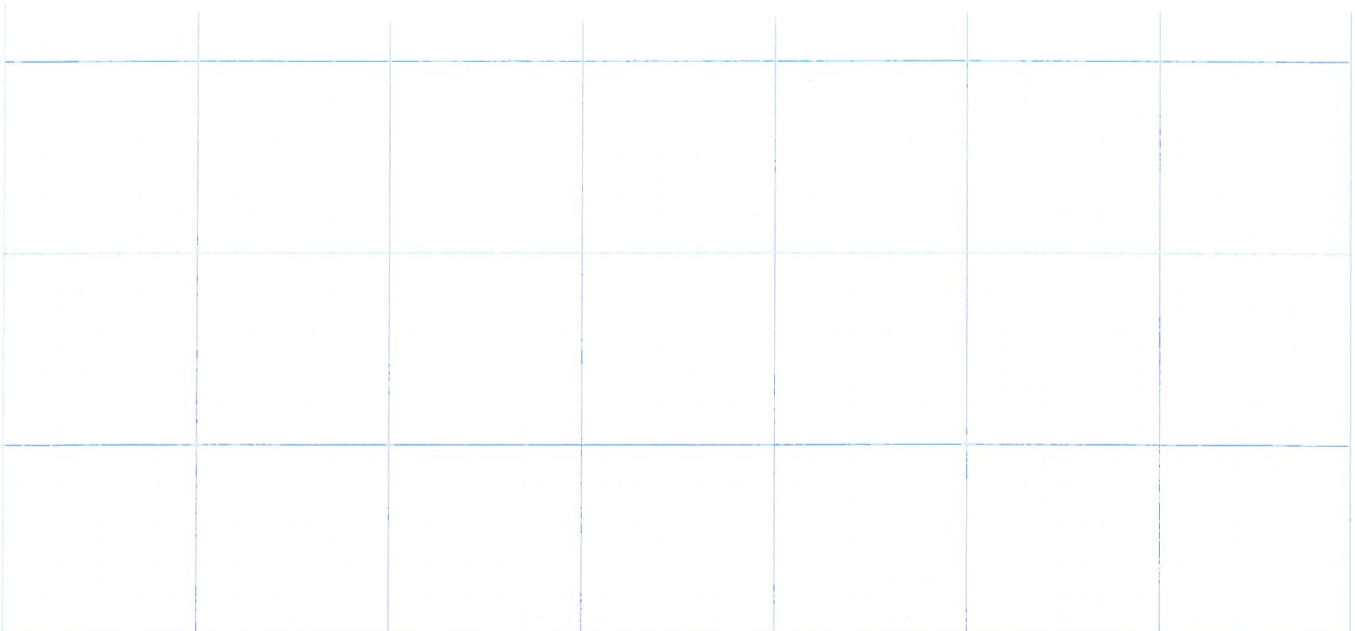

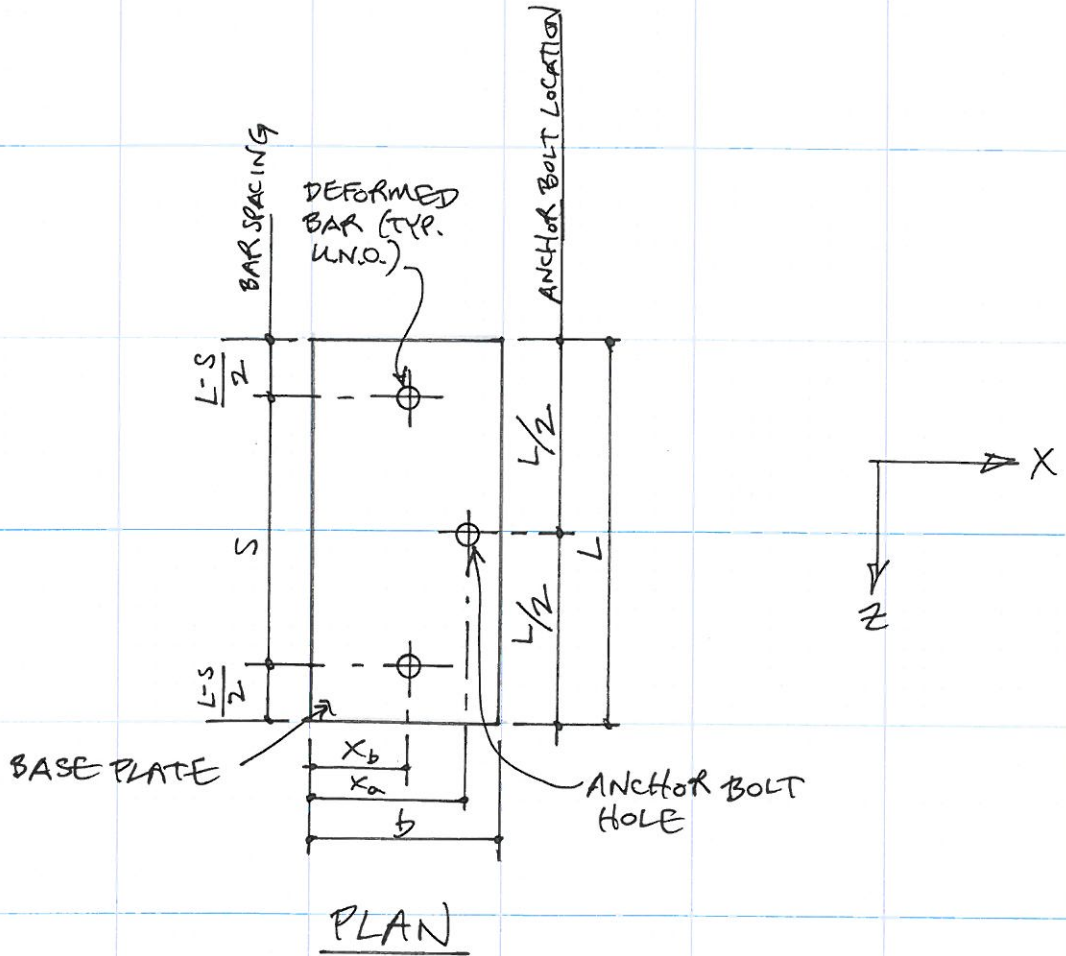

PLAN

